

Phoenix 2240 Series Excel Firefile

- Phoenix 2240 Series offers 1½ Hrs fire resistance at temperature of 1050°C.
- Able to accommodate Fools Cap, A4 and A5 files on width adjustable rails.
- A high security keylock operates independently on each drawer.
- Optional electronic lock available on 2 and 4 drawer files.
- Optional data protection insert available to protect computer media.



Optional Extras Available
 Key lock on each drawer
 REDL2 Electronic Lock
 REDL2 Electronic Lock & Key Lock
 Fingerprint lock
 Cut Key
 Data Protection Insert



Data protection Insert DPI08



Phoenix 2240 Series Excel Firefile

Phoenix (2240 Series) Firefiles have been engineered to withstand temperatures in excess of 1050°C for 90 minutes.

Available in standard two or four drawer versions, all our files feature automatic locking with a single security lock acting on all drawers. Each drawer may be isolated to provide a combination of locked and unlocked drawers at any one time.

Also available as a combination 'Mixed Media File'. Data media such as computer disks and tapes require added protection from heat and moisture, extending the firefiles capability to cater for this requirement is the media chest. This unique data protection unit, fitting snugly into the bottom drawer, provides for ease of use and ensures maximum protection for your valuable data.

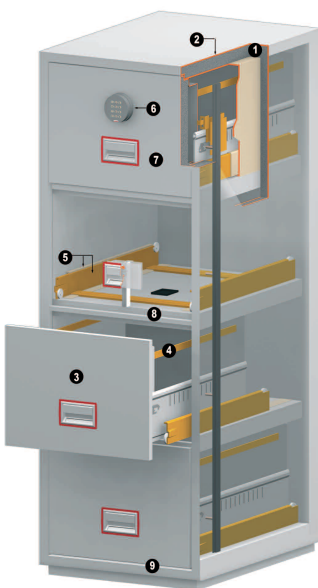

FEATURES

- 1 Insulation is provided by the unique light weight Styronite F insulation material.
- 2 All steel is electrolytic zinc coated to provide for an extended life.
- 3 Applied on top of the quality urethane epoxy primer is a durable urethane hammertone paint. This combination provides for a brighter, smoother and longer lasting finish that resists scratching or marking.
- 4 Hanging rails are adjustable to accommodate foolscap, A4 and A5 files.
- 5 Heavy duty slide rails allow the drawer to move back and forth smoothly while carrying up to a massive 50kg of filing.
- 6 Locking can be by the standard high security key lock, optional user friendly electronic lock or optional fingerprint lock.
- 7 Recessed handle is neat, easy to use and fitted with index card.
- 8 Each drawer is individually insulated for better fire protection.
- 9 Tight construction of body and drawer prevent smoke and heat damage to the contents.

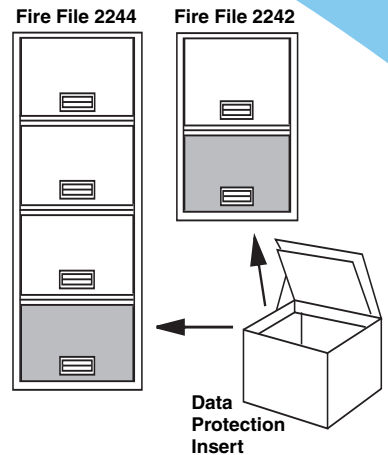

● Dimensions stated as:

- A Height
- B Width
- C Depth*
- D Weight
- E No. of drawers

● Firefile 2242

- A 805mm
- B 530mm
- C 675mm*
- D 145 kgs
- E 2

● Firefile 2244

- A 1495mm
- B 530mm
- C 675mm
- D 266 kgs
- E 4

● Dpi08 (2242 / 2244)

- A (External) 260mm (Internal) 145mm
- B (External) 400mm (Internal) 260mm
- C (External) 500mm (Internal) 380mm

All weights and sizes are approximate.

All Phoenix Fire Safes come with a Free lifetime 'after the fire' replacement warranty and a full two year materials and labour warranty.

Phoenix policy is one of constant improvement. We therefore reserve the right to alter any part of the specification achieved in this publication without incurring any obligation.

DEALER'S STAMP



Certificate No. 1059/96

2240 / 02 08 GB